



COUNTY OF IMPERIAL

PUBLIC SAFETY FACILITY IMPROVEMENTS

AT 518 RAILROAD AVENUE, WINTERHAVEN CA;

COUNTY PROJECT NO. SR5315ADM

GENERAL NOTES

COUNTY ENCROACHMENT PERMIT CONDITIONS AND PROVISIONS SHALL TAKE PRECEDENCE OVER THE APPROVED PLANS AND SPECIFICATIONS FOR ANY CONFLICTS.

THE STRUCTURAL SECTIONS SHALL BE IN ACCORDANCE WITH IMPERIAL COUNTY STANDARDS (OR CALTRANS IF IN STATE ROW) AND AS APPROVED BY THE PUBLIC WORKS DIRECTOR (OR CALTRANS).

APPROVAL OF THESE IMPROVEMENT PLANS AS SHOWN DOES NOT CONSTITUTE APPROVAL OF ANY CONSTRUCTION OUTSIDE THE PROJECT BOUNDARY.

LOCATION AND ELEVATIONS OF IMPROVEMENTS TO BE MET BY WORK TO BE DONE SHALL BE CONFIRMED BY FIELD MEASUREMENTS PRIOR TO CONSTRUCTION OF NEW WORK. CONTRACTOR WILL MAKE EXPLORATORY EXCAVATIONS AND LOCATE EXISTING UNDERGROUND FACILITIES SUFFICIENTLY AHEAD OF CONSTRUCTION TO PERMIT REVISIONS TO PLANS IF REVISION ARE NECESSARY BECAUSE OF ACTUAL LOCATION OF EXISTING FACILITIES.

UTILITIES COORDINATION

NO LESS THAN 3 WORKING DAYS PRIOR TO ANY EXCAVATION OR TRENCHING, EACH CONTRACTOR DOING SUCH WORK SHALL CONTACT THE FOLLOWING AGENCIES SO THAT EXISTING UNDERGROUND UTILITIES MAY BE LOCATED. THE AGENCY MAY REQUIRE AN INSPECTOR TO BE PRESENT.

GAS:	TELEPHONE NO.	811
IID POWER:	TELEPHONE NO.	(760) 339-9280
IID WATER:	TELEPHONE NO.	(760) 339-9263
AT&T TELEPHONE:	TELEPHONE NO.	(800) 422-4133
CATV:	TELEPHONE NO.	(760) 312-8512
WATER AND SEWER - WINTERHAVEN DISTRICT	TELEPHONE NO.	(760) 572-0177
TDS TELECOM	TELEPHONE NO.	(760) 572-7100
TIME WARNER COMM.	TELEPHONE NO.	(760) 694-8670

EXISTING UNDERGROUND UTILITIES BEFORE EXCAVATING FOR THIS CONTRACT, VERIFY LOCATION OF UNDERGROUND UTILITIES. THE EXISTENCE AND LOCATION OF ANY UNDERGROUND UTILITY PIPES OR STRUCTURES SHOWN ON THESE PLANS HAS BEEN OBTAINED FROM AVAILABLE RECORDS ONLY AND MAY NOT REFLECT ALL EXISTING UTILITIES. LOCATION OF ALL EXISTING UTILITIES SHALL BE CONFIRMED BY FIELD MEASUREMENTS BY CONTRACTOR PRIOR TO CONSTRUCTION OF WORK. CONTRACTOR IS REQUIRED TO TAKE PRECAUTIONARY MEASURES TO PROTECT THE UTILITY LINES SHOWN HEREON AND ANY OTHER EXISTING LINES NOT OF RECORD OR NOT SHOWN ON THESE PLANS.

ACCURATE VERIFICATIONS AS TO SIZE, LOCATION AND DEPTH OF EXISTING UNDERGROUND SERVICES SHALL BE THE CONTRACTOR'S RESPONSIBILITY. THE CONTRACTOR SHALL NOTIFY THE SOUTHERN CALIFORNIA GAS COMPANY, IMPERIAL IRRIGATION DISTRICT AND ANY OTHER AFFECTED UTILITY AGENCIES PRIOR TO STARTING HIS WORK NEAR SUCH UTILITY FACILITIES AND SHALL COORDINATE HIS WORK WITH UTILITY REPRESENTATIVES. FOR LOCATION OF UNDERGROUND UTILITIES AND APPURTENANCES, CONTACT "UNDERGROUND SERVICE ALERT" AT 811.

IT SHALL BE THE RESPONSIBILITY OF THE DEVELOPER TO CONTACT THE UTILITY AGENCIES, ADVISE THEM OF THE PROPOSED IMPROVEMENTS AND BEAR THE COST OF RELOCATIONS, IF NEEDED.

CONTRACTOR WILL BE RESPONSIBLE FOR THE REPLACEMENT OF ANY STRIPING, PAVEMENT MARKERS, OR LEGENDS OBLITERATED BY THE CONSTRUCTION OF THIS PROJECT.

THE CONTRACTOR SHALL DO ALL NEW STRIPING AND SANDBLASTING OF REDUNDANT STRIPING.

THE CONTRACTOR SHALL BE RESPONSIBLE TO SECURE AN ENCROACHMENT PERMIT FROM THE COUNTY OF IMPERIAL DEPARTMENT OF PUBLIC WORKS FOR ANY EXCAVATION OR CONSTRUCTION WITHIN COUNTY ROAD RIGHT-OF-WAY. FOR INSPECTIONS, TWO WORKING DAYS MINIMUM NOTICE IS REQUIRED, (442) 265-1818. ADDITIONALLY, UNDERGROUND SERVICE ALERT (USA) MUST BE CALLED TWO WORKING DAYS BEFORE THE CONTRACTOR MAY EXCAVATE. THEIR CONTACT NUMBER IS 811. ALL WORK AND MATERIALS ARE SUBJECT TO THE INSPECTION AND APPROVAL FROM THE COUNTY DEPARTMENT OF PUBLIC WORKS OR THEIR REPRESENTATIVE.

NO REVISIONS OF ANY KIND SHALL BE MADE TO THESE PLANS WITHOUT THE PRIOR WRITTEN APPROVAL OF BOTH THE COUNTY ENGINEER (OR HIS REPRESENTATIVE) AND THE ENGINEER OF RECORD. A REPRODUCIBLE AS-BUILT PLAN SET WILL BE PROVIDED TO THE PUBLIC WORKS DEPARTMENT AS A CONDITION OF SUBSTANTIAL CONSTRUCTION COMPLETION AND PRIOR TO ACCEPTANCE.

ALL WORK AND MATERIALS SHALL CONFORM TO THESE PLANS AND SPECIFICATIONS. THE IMPERIAL COUNTY DEPARTMENT OF PUBLIC WORKS STANDARDS AND ENCROACHMENT PERMIT CONDITIONS, ANY REFERENCED STANDARDS AND SPECIFICATIONS AND THE SPECIFICATIONS & THE REQUIREMENTS OF THE AGENCIES REFERRED TO HEREIN. ALL WORK SHOWN OR INDICATED BY THESE PLANS SHALL BE COMPLETED IN ACCORDANCE WITH THE STANDARDS, POLICIES AND REGULATIONS OF IMPERIAL COUNTY, WHERE, OR IF, CONFLICTS OCCUR, THEN THE IMPERIAL COUNTY REQUIREMENTS SHALL GOVERN.

UNLESS SPECIFICALLY INDICATED OTHERWISE METHODS EMPLOYED AND MATERIAL USED IN THE CONSTRUCTION OF ALL OFFSITE IMPROVEMENTS SHALL CONFORM TO THE APPLICABLE PROVISIONS OF THE "STATE OF CALIFORNIA, DEPARTMENT OF TRANSPORTATION STANDARD SPECIFICATIONS DATED MAY 2006". ALL WORK IS SUBJECT TO INSPECTION AND APPROVAL AS REQUIRED.

IT SHALL BE THE RESPONSIBILITY OF THE CONTRACTOR TO OBTAIN AN EXCAVATION PERMIT FROM THE STATE OF CALIFORNIA DIVISION OF SAFETY AND TO ADHERE TO ALL PROVISIONS OF THE STATE CONSTRUCTION SAFETY ORDERS AND STANDARDS.

TRAFFIC CONTROL SHALL BE IN ACCORDANCE WITH THE CURRENT WORK AREA TRAFFIC CONTROL HANDBOOK OR AS DIRECTED BY THE IMPERIAL COUNTY TRAFFIC ENGINEER.

ANY EXISTING SURVEY MONUMENTS OR COUNTY RECOGNIZED BENCHMARKS SHALL BE PROTECTED BY THE CONTRACTOR. SHOULD ANY SUCH MONUMENTS OR BENCHMARKS BE REMOVED, DAMAGED, OBLITERATED OR ALTERED BY THE CONTRACTOR'S OPERATIONS, THE CONTRACTOR SHALL BE RESPONSIBLE FOR REPLACING OR RESETTING OF THE SAME AS PER THE SUBDIVISION MAP ACT, THE PROFESSIONAL LAND SURVEYORS ACT AND THE SATISFACTION OF THE COUNTY SURVEYOR/DIRECTOR OF PUBLIC WORKS. SUCH POINTS SHALL BE REFERENCED AND REPLACED WITH APPROPRIATE MONUMENTATION BY A LICENSED LAND SURVEYOR OR A REGISTERED CIVIL ENGINEER AUTHORIZED TO PRACTICE LAND SURVEYING. A CORNER RECORD OR RECORD OF SURVEY AS APPROPRIATE SHALL BE FILED BY THE LICENSED LAND SURVEYOR OR REGISTERED CIVIL ENGINEER.

DUST SHALL BE CONTROLLED BY THE CONTRACTOR IN ACCORDANCE WITH ALL IMPERIAL COUNTY AIR POLLUTION CONTROL DISTRICT (APCD) FUGITIVE DUST CONTROL RULES AND REGULATIONS AND SHALL COMPLY WITH THEIR PERMITTING REQUIREMENTS, IF APPLICABLE.

THE NOTES LISTED ABOVE ARE A MINIMUM LIST. THIS DOES NOT RELIEVE THE ENGINEER FROM COMPILING ADDITIONAL NOTES THAT MAY BE REQUIRED FOR THE PROJECT.

PROJECT INFORMATION

OWNER

COUNTY OF IMPERIAL
940 W. MAIN STREET
EL CENTRO, CA 92243
TEL. 442-265-1818

ENGINEER

DYNAMIC CONSULTING ENGINEERS, INC.
2415 IMPERIAL BUSINESS PARK DR. STE. B
IMPERIAL, CA 92251
TEL. (760) 545-0162
FAX. (760) 545-0163

GEOTECHNICAL ENGINEER

LANDMARK CONSULTANTS INC.
WINTERHAVEN PUBLIC SAFETY FACILITY
REPORT NO. LE15031
780 4. 4TH STREET
EL CENTRO CA 92243
TEL. 760-370-3000

NOTE TO CONTRACTOR

CONSTRUCTION CONTRACTOR AGREES THAT IN ACCORDANCE WITH GENERALLY ACCEPTED CONSTRUCTION PRACTICES, CONSTRUCTION CONTRACTOR WILL BE REQUIRED TO ASSUME SOLE AND COMPLETE RESPONSIBILITY FOR JOB SITE DURING THE COURSE OF CONSTRUCTION OF THE PROJECT, INCLUDING SAFETY OF ALL PERSONS AND PROPERTY. THIS REQUIREMENT SHALL BE MADE TO APPLY CONTINUOUSLY AND NOT BE LIMITED TO NORMAL WORKING HOURS, AND CONSTRUCTION CONTRACTOR FURTHER AGREES TO DEFEND, INDEMNIFY AND HOLD DESIGN PROFESSIONAL HARMLESS FROM ANY AND ALL LIABILITY, REAL OR ALLEGED, IN CONNECTION WITH THE PERFORMANCE OF WORK ON THIS PROJECT, EXCEPTING LIABILITY ARISING FROM THE SOLE NEGLIGENCE OF DESIGN PROFESSIONAL.

ENGINEER'S NOTE TO CONTRACTOR

THE EXISTENCE AND LOCATION OF ANY UNDERGROUND UTILITY PIPES, CONDUITS OR STRUCTURES SHOWN ON THESE PLANS ARE OBTAINED BY A SEARCH OF THE AVAILABLE RECORDS. TO THE BEST OF OUR KNOWLEDGE THERE ARE NO EXISTING UTILITIES EXCEPT AS SHOWN ON THESE PLANS. THE CONTRACTOR IS REQUIRED TO TAKE DUE PRECAUTIONARY MEASURES TO PROTECT THE UTILITY LINES SHOWN ON THESE DRAWINGS. THE CONTRACTOR FURTHER ASSUMES ALL LIABILITY AND RESPONSIBILITY FOR THE UTILITY PIPES, CONDUITS OR STRUCTURES SHOWN OR NOT SHOWN ON THESE DRAWINGS.

DECLARATION OF RESPONSIBLE CHARGE

I HEREBY DECLARE THAT I AM THE ENGINEER OF WORK FOR THE PROJECT, THAT I HAVE EXERCISED RESPONSIBLE CHARGE OVER THE DESIGN OF THE PROJECT AS DEFINED IN SECTION 6703 OF THE BUSINESS AND PROFESSIONS CODE, AND THAT THE DESIGN IS CONSISTENT WITH CURRENT STANDARDS.

I UNDERSTAND THAT THE CHECK OF PROJECT DRAWINGS AND SPECIFICATIONS BY THE CITY OF EL CENTRO IS CONFINED TO A REVIEW ONLY AND DOES NOT RELIEVE ME, AS ENGINEER OF WORK, OF MY RESPONSIBILITIES FOR THE PROJECT DESIGN.

CARLOS BELTRAN, P.E.
DYNAMIC CONSULTING ENGINEERS, INC.
2415 IMPERIAL BUSINESS PARK DR. STE. B
IMPERIAL, CA 92251
(760) 545-0162

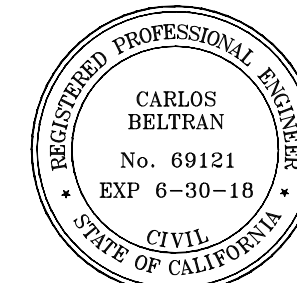

CARLOS BELTRAN, P.E. DATE
R.C.E. # 69121

TOPOGRAPHICAL SURVEY CONDUCTED BY
DYNAMIC CONSULTING ENGINEERS ON JANUARY
2015.

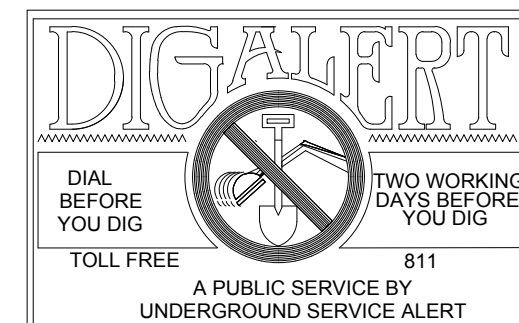

VICINITY MAP

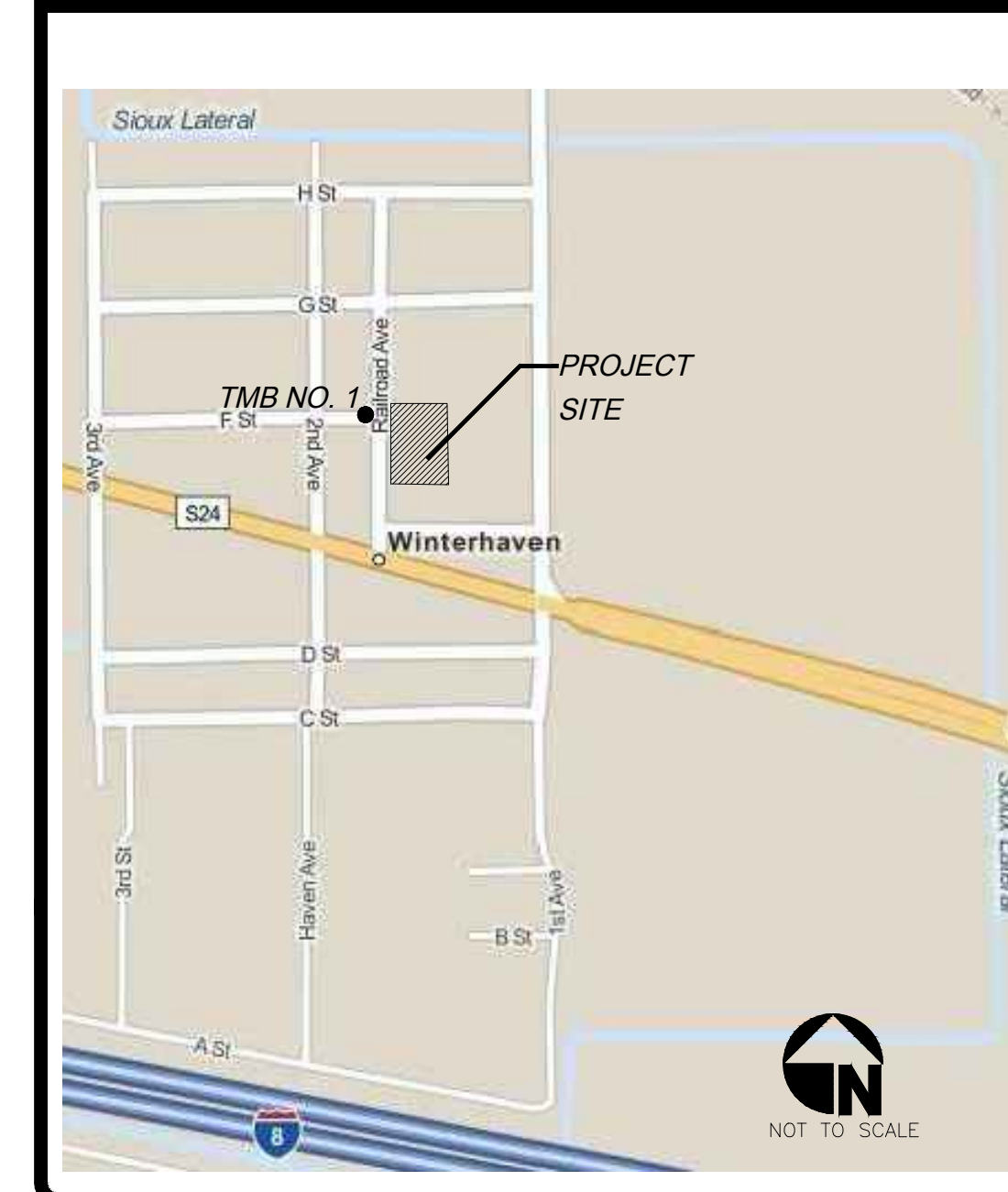

ABBREVIATIONS

AGG.	AGGREGATE	MIN	MINIMUM
APPROX.	APPROXIMATE	N	NORTH
Asph.	ASPHALT	N/O	NORTH OF
B.M.	BENCHMARK	OHE	OVER HEAD ELECTRIC
CL OR CL	CENTERLINE	PROP.	PROPOSED
CLR	CLEARANCE	R/W OR ROW	RIGHT-OF-WAY
CONC.	CONCRETE	RD	ROAD
E	EAST	STA.	STATION
E.P.	EDGE OF PAVEMENT	S	SEWER
EL. OR ELEV.	ELEVATION	SD	STORM DRAIN
EX. OR EXIST.	EXISTING	T.P.	TOP OF PAVEMENT
F.L.	FLOW LINE	TYP	TYPICAL
F.S.	FINISH SURFACE	W	WATER
MAX	MAXIMUM	W/O	WEST OF

BENCHMARK

PROJECT BENCHMARK:
THE PROJECT BENCHMARK IS A STANDARD DISK STAMPED "MISSION 1964" SET IN THE TOP OF A 12-INCH CYLINDRICAL CONCRETE MONUMENT, SET FLUSH WITH THE GROUND. IT IS 40.6 FEET WEST OF THE EAST EDGE OF THE BLUFF AND 10.7 FEET NORTH OF A ROCK RETAINING WALL. TO REACH THE STATION FROM TEH CITY HALL IN YUMA, GO EAST ON 1ST STREET TO PENITENTIARY AVENUE. TURN LEFT AND GO NORTH ON PENITENTIARY AVENUE 0.6 MILE TO A FORK AT THE NORTH END OF THE COLORADO RIVER BRIDGE. CONTINUE NORTHWEST 0.1 MILE TO THE SECOND SIDE ROAD ON THE LEFT AT AN OLD BUILDING FOUNDATION. TURN LEFT AND GO SOUTH 100 FEET TO STEEP GRAVEL ROAD UP ONTO KNOLL AND THE STATION. THE BENCHMARK IS APPROXIMATELY 1 MILE EAST OF THE PROJECT.
ELEVATION: 181.10'
TMB NO. 1
TOP OF IRON PIPE FOR THE INTERSECTION CORNER OF "F" STREET AND RAILROAD AVENUE.
ELEVATION: 129.91'

SYMBOLS

ITEM NO.	ITEM	SYMBOL
1	STREET R/W LINE	---
2	STREET CVL	---
3	CABLE TV	--- CABLE
4	DRAIN (FIELD)	---
5	EX. EDGE OF ASPHALT	---
6	PROP. EDGE OF ASPHALT	---
7	EX. ASPHALT CONCRETE	---
8	PROP. ASPHALT CONCRETE	---
9	EDGE OF DIRT	---
10	CONCRETE SECTION	---
11	ROAD STRIPING	---
12	CONTOURS - MAJOR	980
13	CONTOURS - MINOR	980
14	CONTROL	N-17
15	SPOT ELEVATION	+ 961.44
16	BENCHMARK (SEE DESCRIPTION)	+ 967.06±
17	BORROW PIT ELEVATIONS	---
18	PROPOSED BORROW PIT	---

SHEET INDEX

- TITLE SHEET
- DEMOLITION PLAN
- IMPROVEMENTS AND GRADING PLAN
- DETAILS
- DETAILS
- EROSION CONTROL PLAN
- EROSION CONTROL PLAN DETAILS

SOILS ENGINEER

THESE PLANS HAS BEEN REVIEWED BY THE UNDERSIGNED AND FOUND TO BE IN CONFORMANCE WITH THE PROVISIONS OF THE GEOTECHNICAL INVESTIGATION REPORT REVIEW AND UPDATE RECOMMENDATIONS LCI REPORT No. LE15031 DATED MAY 6, 2015 PREPARED BY LANDMARK GEO-ENGINEERS AND GEOLOGISTS, "WINTERHAVEN PUBLIC SAFETY FACILITY AT 518 RAILROAD AVENUE, WINTERHAVEN CA". THIS SOILS REPORT SHALL BE CONSIDERED AS PART OF THESE PLANS.

THE UNDERSIGNED HAS ALSO REVIEWED THESE PLANS AND FOUND THE DESIGNS AND SPECIFICATIONS TO BE IN CONFORMANCE WITH THE PROVISIONS OF THE SOILS REPORT PREPARED BY LANDMARK CONSULTANTS, INC. REPORT No. LE15031.



SIGNED: JEFFREY O. LYON, R.C.E. 31921 DATE:

Dynamic CONSULTING ENGINEERS

CIVIL ENGINEERING - LAND SURVEYING - CONSTRUCTION MANAGEMENT
2415 IMPERIAL BUSINESS PARK DRIVE, SUITE B.,
IMPERIAL, CA. 92251
TEL. (760) 545-0162 FAX (760) 545-0163

REVISION	DATE	COMMENTS
	03/25/2016	PLANS ISSUED FOR PLAN CHECK REVIEW AND PERMITTING

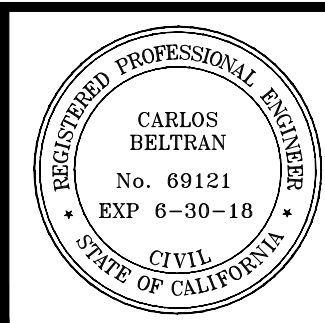

PREPARED UNDER THE DIRECT SUPERVISION OF:
CARLOS BELTRAN, P.E. 69121 R.C.E. No.
DATE 06/30/2018 REG. EXP.

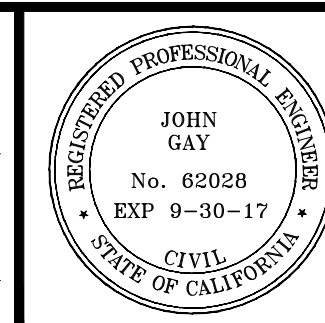

COUNTY OF IMPERIAL PUBLIC WORKS DEPARTMENT
APPROVED FOR CONSTRUCTION BY:
JOHN GAY, P.E. 62028 R.C.E. No.
DIRECTOR OF PUBLIC WORKS 09/30/2017 REG. EXP.
DATE

PUBLIC WORKS DEPARTMENT
COUNTY OF IMPERIAL
EL CENTRO, CALIFORNIA

DATE	03/17/2017
DRAWN	DB
SCALE	AS SHOWN
CHECKED	CB

PUBLIC SAFETY FACILITY IMPROVEMENTS LOCATED AT 518 RAILROAD AVE., WINTERHAVEN CA; COUNTY PROJECT NO. SR5315ADM

TITLE SHEET
REFERENCE PROJECT NO. SR5315ADM SHEET 1 OF 7

DEMOLITION NOTES:

- 1 CLEAR AND GRUB. REMOVE AND DISPOSE EXISTING VEGETATION INCLUDING ALL ROOTS AND ORGANIC MATERIAL.
- 2 REMOVE EXISTING FENCE INCLUDING EXISTING WOODEN POSTS.
- 3 REMOVE AND DISPOSE EXISTING CONCRETE.
- 4 REMOVE EXISTING WATER SERVICE LINE USED FOR THE TEMPORARY FACILITY. CONTRACTOR TO COORDINATE WITH COUNTY STAFF REMOVAL OR ABANDONMENT OF WATER SERVICE.
- 5 REMOVE EXISTING SEWER SERVICE LINE USED FOR TEMPORARY FACILITY. CONTRACTOR MAY ABANDON PIPE IN PLACE IF PIPE IS FILLED WITH LOW STRENGTH SLURRY.

HORIZONTAL CONTROL			
CONTROL	DESCRIPTION	NORTHING	EASTING
1	CENTERLINE MONUMENT AT INTERSECTION OF RAILROAD AVE. AND E STREET	1852374.93	7058340.84
2	CENTERLINE MONUMENT AT INTERSECTION OF 1ST STREET AND E STREET	1852379.95	7058822.93
3	CENTERLINE MONUMENT AT INTERSECTION OF 1ST STREET AND G STREET	1853074.99	7058815.04
4	CENTERLINE MONUMENT AT INTERSECTION OF RAILROAD AVE. AND G STREET	1853070.16	7058333.61
5	CENTERLINE MONUMENT AT INTERSECTION OF RAILROAD AVE. AND F STREET	1852714.86	7058337.40
6	NORTHWEST PROPERTY CORNER	1852750.31	7058362.03
7	NORTHEAST PROPERTY CORNER	1852752.47	7058573.55
8	SOUTHWEST PROPERTY CORNER	1852545.24	7058364.12
9	SOUTHEAST PROPERTY CORNER	1852547.43	7058575.76
10	NORTHWEST BLOCK WALL CORNER	1852749.31	7058362.03
11	NORTHEAST BLOCK WALL CORNER	1852751.45	7058573.32
12	SOUTHWEST BLOCK WALL CORNER	1852545.74	7058364.11
13	SOUTHEAST BLOCK WALL CORNER	1852549.71	7058574.13

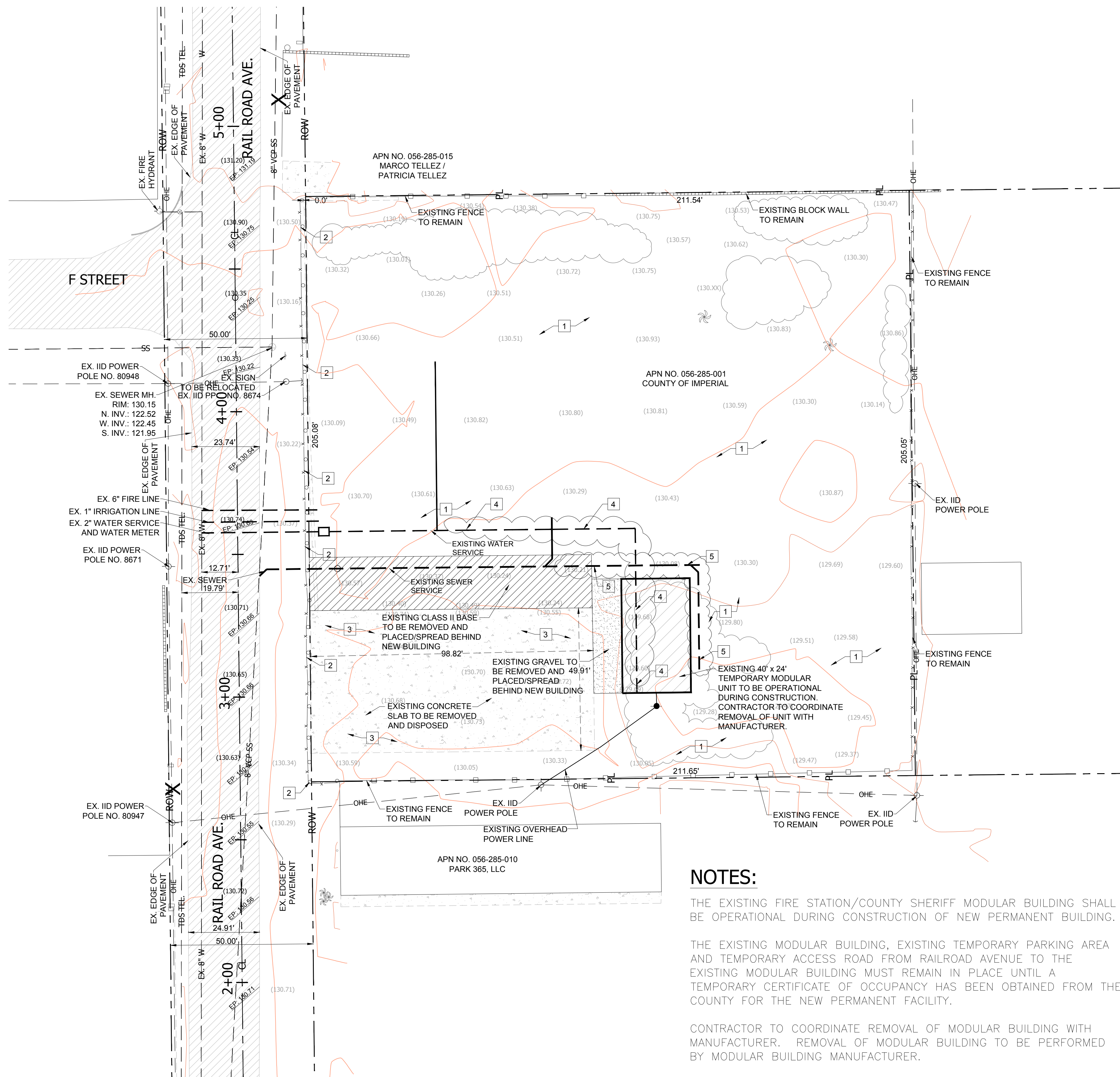

NOTES:

THE EXISTING FIRE STATION/COUNTY SHERIFF MODULAR BUILDING SHALL BE OPERATIONAL DURING CONSTRUCTION OF NEW PERMANENT BUILDING.

THE EXISTING MODULAR BUILDING, EXISTING TEMPORARY PARKING AREA AND TEMPORARY ACCESS ROAD FROM RAILROAD AVENUE TO THE EXISTING MODULAR BUILDING MUST REMAIN IN PLACE UNTIL A TEMPORARY CERTIFICATE OF OCCUPANCY HAS BEEN OBTAINED FROM THE COUNTY FOR THE NEW PERMANENT FACILITY.

CONTRACTOR TO COORDINATE REMOVAL OF MODULAR BUILDING WITH MANUFACTURER. REMOVAL OF MODULAR BUILDING TO BE PERFORMED BY MODULAR BUILDING MANUFACTURER.

CONTRACTOR TO COORDINATE WITH IMPERIAL IRRIGATION DISTRICT SWITCH OF POWER FROM TEMPORARY MODULAR BUILDING TO PERMANENT BUILDING.

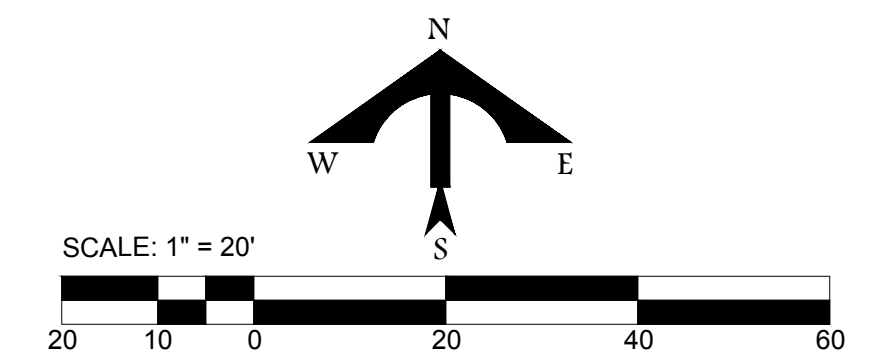

Dynamic CONSULTING ENGINEERS
 CIVIL ENGINEERING - LAND SURVEYING - CONSTRUCTION MANAGEMENT
 2415 IMPERIAL BUSINESS PARK DRIVE, SUITE B.,
 IMPERIAL CA. 92251
 TEL. (760) 545-0162 FAX (760) 545-0163

REVISION	DATE	COMMENTS
	03/25/2016	PLANS ISSUED FOR PLAN CHECK REVIEW AND PERMITTING

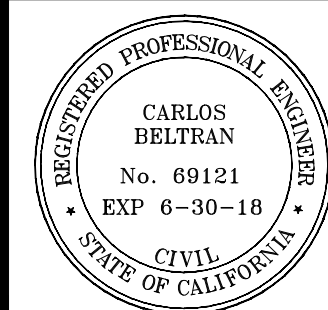

PREPARED UNDER THE DIRECT SUPERVISION OF:
 CARLOS BELTRAN, P.E.
 69121 R.C.E. No.
 DATE 06/30/2018 REG. EXP.

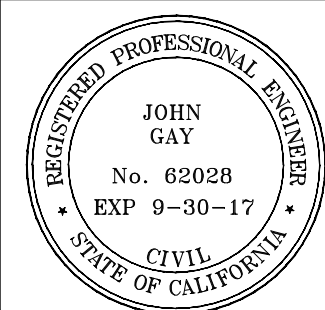

COUNTY OF IMPERIAL PUBLIC WORKS DEPARTMENT
 APPROVED FOR CONSTRUCTION BY:
 JOHN GAY, P.E.
 DIRECTOR OF PUBLIC WORKS
 DATE 09/30/2017 REG. EXP.



DATE 03/17/2017
 DRAWN DB
 SCALE AS SHOWN
 CHECKED CB

PUBLIC SAFETY FACILITY IMPROVEMENTS LOCATED AT 518 RAILROAD AVE., WINTERHAVEN CA; COUNTY PROJECT NO. SR5315ADM

DEMOLITION PLAN
 REFERENCE PROJECT NO. SR5315ADM
 SHEET 2 OF 7

PARKING LOT NOTES:

NOTE: PARKING SPACES SHALL BE STRIPED ACCORDINGLY AND ALL STRIPING SHALL BE MAINTAINED IN ACCORDANCE WITH CALTRANS STANDARD SPECIFICATIONS.

- 20 PAINT 4 INCH WHITE STRIPE PARKING STALL
- 21 PAINT ACCESSIBLE PARKING STALL AND AISLE PER 2013 CA BUILDING CODES. INSTALL REQUIRED ACCESSIBLE PARKING SIGNS.

SITE DEVELOPMENT AND GRADING

CLEARING AND GRUBBING: AT THE TIME OF CONSTRUCTION, ALL EXISTING PAVEMENT, DEBRIS AND VEGETATION SUCH AS GRASS, BRUSH, AND TREES ON THE SITE SHOULD BE REMOVED. ORGANIC STRIPPINGS SHOULD BE HAULED FROM THE SITE AND SHOULD NOT BE INCORPORATED INTO ANY ENGINEERED FILLS. ANY TRASH, CONSTRUCTION DEBRIS, CONCRETE SLABS, OLD PAVEMENT, LANDFILL, AND BURIED OBSTRUCTIONS SHOULD BE LOCATED BY THE GRADING CONTRACTOR AND REMOVED. EXCAVATIONS RESULTING FROM SITE CLEARING SHOULD BE DISH-SHAPED TO THE LOWEST DEPTH OF DISTURBANCE AND BACKFILLED WITH ENGINEERED FILL AS DESCRIBED IN THE GEOTECHNICAL REPORT.

MASS GRADING: THE SURFACE SOILS ARE LOOSE WITH 2 TO 4 INCHES OF "FLUFF" ON THE SURFACE, AS INDICATED BY WHEEL LOAD DEPRESSIONS. PRIOR TO PLACING ANY FILLS, THE SURFACE 24 INCHES OF SOIL SHOULD BE REMOVED, THE EXPOSED SURFACE UNIFORMLY MOISTURE CONDITIONED TO A DEPTH OF 8 INCHES BY DISCING AND WETTING TO A MINIMUM OF OPTIMUM PLUS 5% AND RECOMPACTED TO 87% TO 92% OF ASTM D1557 MAXIMUM DENSITY. ONSITE NATIVE CLAYS PLACED AS ENGINEER FILL SHOULD BE UNIFORMLY MOISTURE CONDITIONED BY DISCING AND WETTING OR DRYING TO OPTIMUM PLUS 5 TO 10% AND COMPACTED IN 6 INCH MAXIMUM LIFTS TO 87% TO 92% RELATIVE COMPACTION. CLODS SHALL BE REDUCED BY DISCING TO A MAXIMUM DIMENSION OF 1.0 INCH PRIOR TO BEING PLACED AS FILL.

BUILDING PAD PREPARATION: BUILDING PAD SHALL BE PREPARED PER THE RECOMMENDATIONS OF THE GEOTECHNICAL REPORT PREPARED BY LANDMARK CONSULTANTS, INC. DATED MAY 6, 2015 "WINTERHAVEN PUBLIC SAFETY FACILITY 518 RAILROAD AVENUE, WINTERHAVEN CA, REPORT NO. LE15031.

REMOVE THE UPPER 3 FEET OF SOILS BENEATH BUILDINGS AND THE UPPER 12 INCHES BENEATH PAVED AND HARDCAPED AREAS AND REPLACE WITH COMPACTED NON-EXPANSIVE GRANULAR FILL. AN ENGINEERED BUILDING SUPPORT PAD CONSISTING OF 3.0 FEET OF GRANULAR SOIL, PLACED IN MAXIMUM 8-INCH LIFTS (LOOSE), COMPACTED TO A MINIMUM OF 95% OF ASTM D1557 MAXIMUM DENSITY AT 2% BELOW TO 4% ABOVE OPTIMUM MOISTURE, SHOULD BE PLACED BELOW THE BOTTOM OF THE SLAB.

REMOVAL AND REPLACEMENT SHALL EXTEND AT LEAST 5 FT BEYOND THE BUILDING FOOTPRINT AND AT LEAST 1 FOOT BEYOND SIDEWALKS LOCATED NEXT TO THE BUILDING.

BUILDING PAD PREPARATION AREA (FOR ILLUSTRATION PURPOSE ONLY)

DESIGN FINISH FLOOR (F.F.) ELEV. = 131.60

DESIGN FINISH PAD ELEV. = 130.93

EXISTING ELEV. (APPROXIMATE) = 130.50

REMOVE THE UPPER 3 FEET OF SOILS BENEATH BUILDINGS AND REPLACE WITH COMPACTED NON-EXPANSIVE GRANULAR FILL. FILL SHOULD BE PLACED IN MAXIMUM 8-INCH LIFTS AND COMPACTED TO AT LEAST 95% RELATIVE COMPACTION (TYP.)

BOTTOM OF SUB-EXCAVATION = 127.93

SCARIFY AND RECOMPACT SEE GRADING NOTES

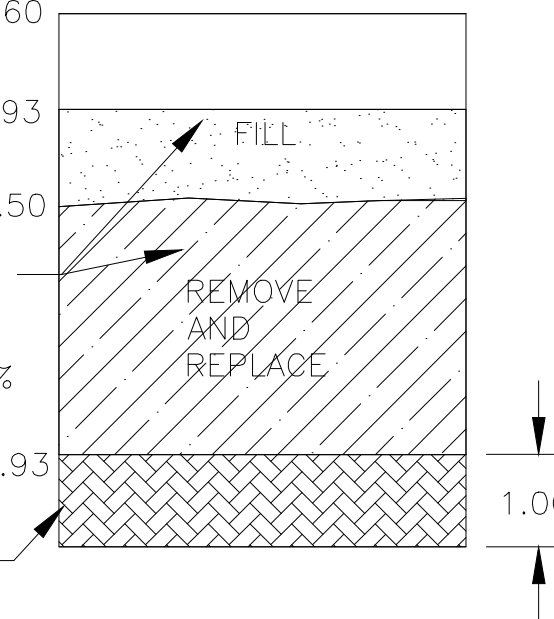

HYDROLOGY ANALYSIS SUMMARY:

ON-SITE ANALYSIS:

PROJECT SITE AREA:.....43,380 SF
ON-SITE RETENTION REQUIRED (@ 3" STORM EVENT):10,845 CF

PROPOSED SOUTH RETENTION BASIN AREA:.....5,213 SF
DEPTH OF SOUTH RETENTION BASIN:.....3.5 FT
SOUTH RETENTION BASIN CAPACITY:.....12,278 CF

PROPOSED NORTH RETENTION BASIN AREA:.....1,750 SF
DEPTH OF NORTH RETENTION BASIN:.....2.5 FT
NORTH RETENTION BASIN CAPACITY:.....3,372 CF

TOTAL RETENTION BASIN CAPACITY (BOTH BASINS):.....15,650 CF

OFF-SITE ANALYSIS:

OFF SITE STORM TRIBUTARY AREA:.....11,491 SF
OFF-SITE RETENTION REQUIRED (@ 3" STORM EVENT):2,872 SF

TOTAL RETENTION BASIN REQUIRED (OFF-SITE AND ON-SITE): 13,717 SF

EARTHWORK QUANTITIES (APPROXIMATE)

EXPORT MATERIAL (BUILDING PAD) = 1,400 CY
EXPORT MATERIAL (RET. BASINS) = 580 CY
EXPORT MATERIAL (FLAT WORK) = 1,015 CY
TOTAL EXPORT MATERIAL = 2,995 CY

IMPORT FILL MATERIAL (BUILDING PAD) = 1,450 CY
IMPORT FILL MATERIAL (FLAT WORK) = 550 CY
TOTAL IMPORT MATERIAL = 2,000 CY

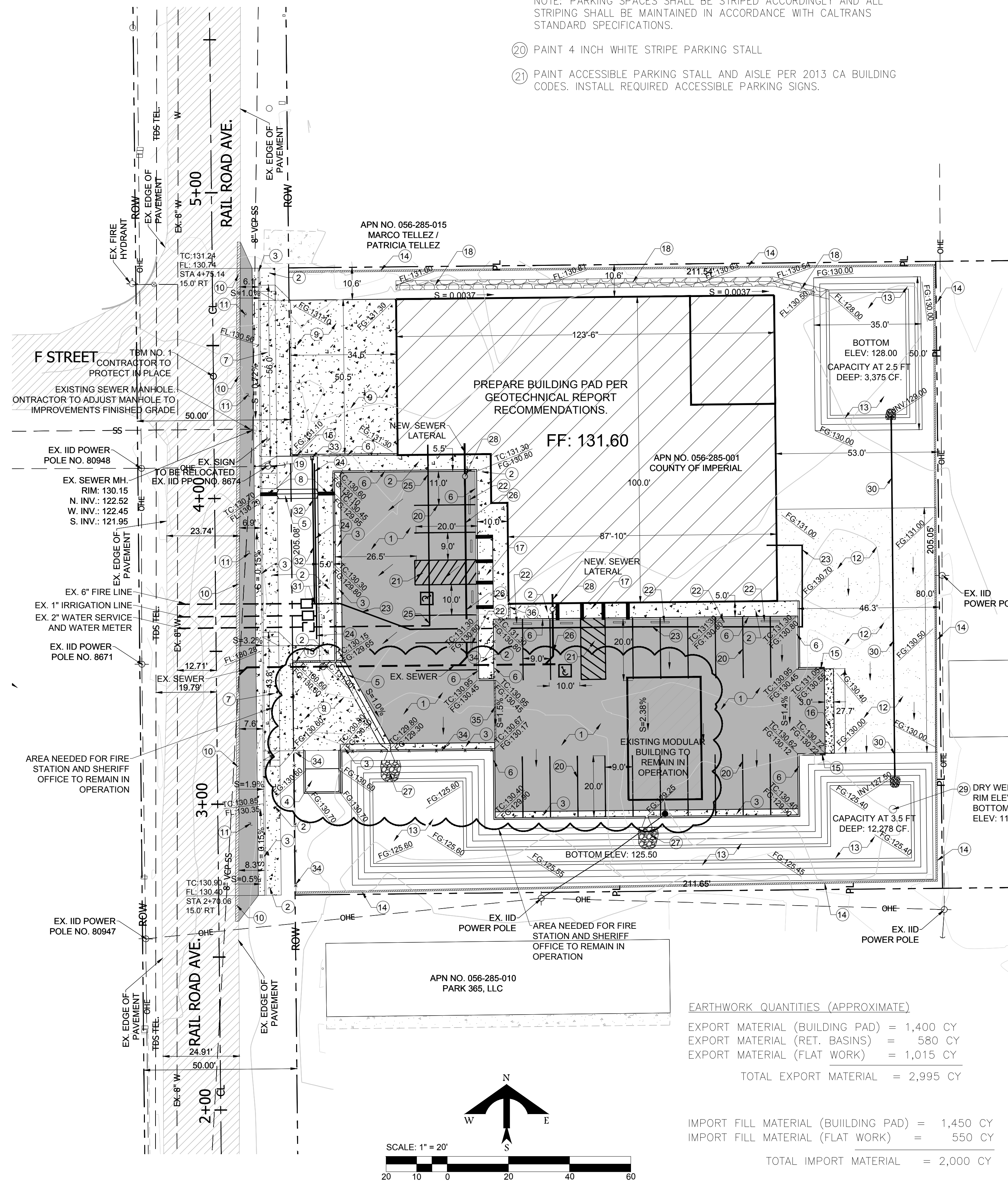

CONSTRUCTION NOTES:

- 1 INSTALL 3" OF ASPHALT CONCRETE OVER 8 INCHES OF CLASS II BASE. CLASS II BASE TO BE COMPACTED TO 95%. REMOVE AND DISPOSE UNSUITABLE MATERIAL PER GEOTECHNICAL REPORT AND GENERAL NOTES THIS SHEET. SCARIFY AND RECOMPACT 12" OF SUBGRADE TO 90% COMPACTION SEE DETAIL 14 SHEET 5
- 2 INSTALL SIDEWALK PER DETAILS 7 SHEET 4. REMOVE AND DISPOSE UNSUITABLE MATERIAL PER GEOTECHNICAL REPORT AND GENERAL NOTES THIS SHEET
- 3 INSTALL CURB AND GUTTER PER DETAIL 2 SHEET 4
- 4 INSTALL NEW TRASH ENCLOSURE PER DETAIL 3 SHEET 4
- 5 INSTALL NEW 3 FT P.C.C. RIBBON GUTTER PER DETAIL 1 SHEET 4
- 6 INSTALL P.C.C. FREE STANDING CURB PER DETAIL 8 SHEET 4
- 7 NEW P.C.C. DRIVEWAY PER DETAIL 11 SHEET 5
- 8 INSTALL SIDEWALK DRAIN PER DETAIL 10 SHEET 5
- 9 PLACE 8 INCH CONCRETE SLAB WITH NO. 4 REBAR 18 INCHES OF CENTER WITH 3 INCH CLEARANCE. CONCRETE TO BE PLACED OVER 12 INCHES OF CLASS II BASE COMPACTED TO 95%. REMOVE AND DISPOSE UNSUITABLE MATERIAL PER GEOTECHNICAL REPORT AND GENERAL NOTES THIS SHEET. SCARIFY AND RECOMPACT 12" OF SUBGRADE TO 90% COMPACTION.
- 10 INSTALL PAVEMENT JOINER STRIP PER DETAIL 12 SHEET 5
- 11 INSTALL 3" OF ASPHALT CONCRETE OVER 9 INCHES OF CLASS II BASE. CLASS II BASE TO BE COMPACTED TO 95%. REMOVE AND DISPOSE UNSUITABLE MATERIAL PER GEOTECHNICAL REPORT AND GENERAL NOTES THIS SHEET. SCARIFY AND RECOMPACT 12" OF SUBGRADE TO 90% COMPACTION SEE DETAIL 13 SHEET 5
- 12 INSTALL 3 INCHES OF CLASS II BASE COMPACTED TO 95% RELATIVE COMPACTION FOR PARKING AREA
- 13 CONSTRUCT RETENTION BASIN. BOTTOM OF RETENTION BASIN TO BE UNCOMPACTED NATIVE MATERIAL. CONTRACTOR TO PROPERLY DISPOSE EXPORT MATERIAL.
- 14 INSTALL 6-FT PERIMETER CMU WALL PER DETAIL 15 SHEET 5
- 15 INSTALL DEPRESSED CURB
- 16 INSTALL 6 INCH CONCRETE TRANSITION OVER 6 INCH CLASS II BASE COMPACTED TO 95% RELATIVE COMPACTION. SCARIFY AND RECOMPACT 12 INCHES OF NATIVE MATERIAL TO 90% RELATIVE COMPACTION.
- 17 INSTALL ACCESSIBLE RAMP PER DETAIL 4 SHEET 4
- 18 INSTALL 3 FT WIDE DRAINAGE SWALE SEE DETAIL 5 SHEET 4
- 19 EXISTING IID POWER POLE TO BE RELOCATED AWAY FROM PROPOSED SIDEWALK. COORDINATE RELOCATION WITH IID ENERGY DEPARTMENT
- 22 INSTALL WHEEL STOP PER DETAIL 16 ON SHEET 5 AND DETAIL 6 ON SHEET 4.
- 23 INSTALL 6" BACKFLOW PREVENTER AND FIRE LINE EXTENSION
- 24 INSTALL 1" IRRIGATION LINE EXTENSION, BACKFLOW PREVENTER AND 1-INCH WATER METER PER COUNTY DETAIL
- 25 INSTALL NEW 2 INCH BACKFLOW PREVENTER AND WATER LINE EXTENSION TO NEW BUILDING
- 26 INSTALL NEW 4' SEWER LATERAL
- 27 INSTALL 6 FT BY 7 FT BY 9 INCH THICK 4"-6" DIAM. RIP RAP
- 28 INSTALL SEWER CLEAN OUT PER COUNTY OF IMPERIAL DETAIL 223
- 29 INSTALL 4-FT DIAM. DRYWELL. CONTRACTOR TO SUBMIT SHOP DRAWINGS FOR COUNTY APPROVAL.
- 30 INSTALL 8" PVC STORM DRAIN PIPE
- 31 INSTALL 6" x 6" x 2" DUCTILE IRON TEE.
- 32 INSTALL 2" WATER LINE
- 33 INSTALL CLASS I STAND PIPE WITH A 2 1/2" FIRE HOSE CONNECTION
- 34 INSTALL 6 FT HIGH WROUGHT IRON FENCE
- 35 INSTALL 20 FT AUTOMATIC GATE
- 36 INSTALL PEDESTRIAN GATE

Dynamic CONSULTING ENGINEERS
CIVIL ENGINEERING - LAND SURVEYING - CONSTRUCTION MANAGEMENT
2415 IMPERIAL BUSINESS PARK DRIVE, SUITE B., IMPERIAL, CA. 92251
TEL. (760) 545-0162 FAX (760) 545-0163

REVISION	DATE	COMMENTS
1	03/25/2017	PLANS ISSUED FOR PLAN CHECK REVIEW AND PERMITTING
2	05/26/2017	ADDED WROUGHT IRON FENCE, 20-FT AUTOMATIC GATE AND PEDESTRIAN GATE. SEE CONSTRUCTION NOTES 34, 35 & 36

PREPARED UNDER THE DIRECT SUPERVISION OF:
CARLOS BELTRAN, P.E.
No. 69121
EXP 6-30-18
CIVIL ENGINEER STATE OF CALIFORNIA

DATE: 06/30/2018
REG. EXP.:

COUNTY OF IMPERIAL PUBLIC WORKS DEPARTMENT
APPROVED FOR CONSTRUCTION BY:
JOHN GAY, P.E.
DIRECTOR OF PUBLIC WORKS
No. 62028
R.C.E. No.
09/30/2017
REG. EXP.

PUBLIC WORKS DEPARTMENT
COUNTY OF IMPERIAL
EL CENTRO, CALIFORNIA

DATE: 03/17/2017
DRAWN: DB
SCALE: AS SHOWN
CHECKED: CB

PUBLIC SAFETY FACILITY IMPROVEMENTS LOCATED AT 518 RAILROAD AVE., WINTERHAVEN CA; COUNTY PROJECT NO. SR5315ADM

IMPROVEMENTS AND GRADING PLAN

REFERENCE PROJECT NO. SR5315ADM

SHEET 3 OF 7

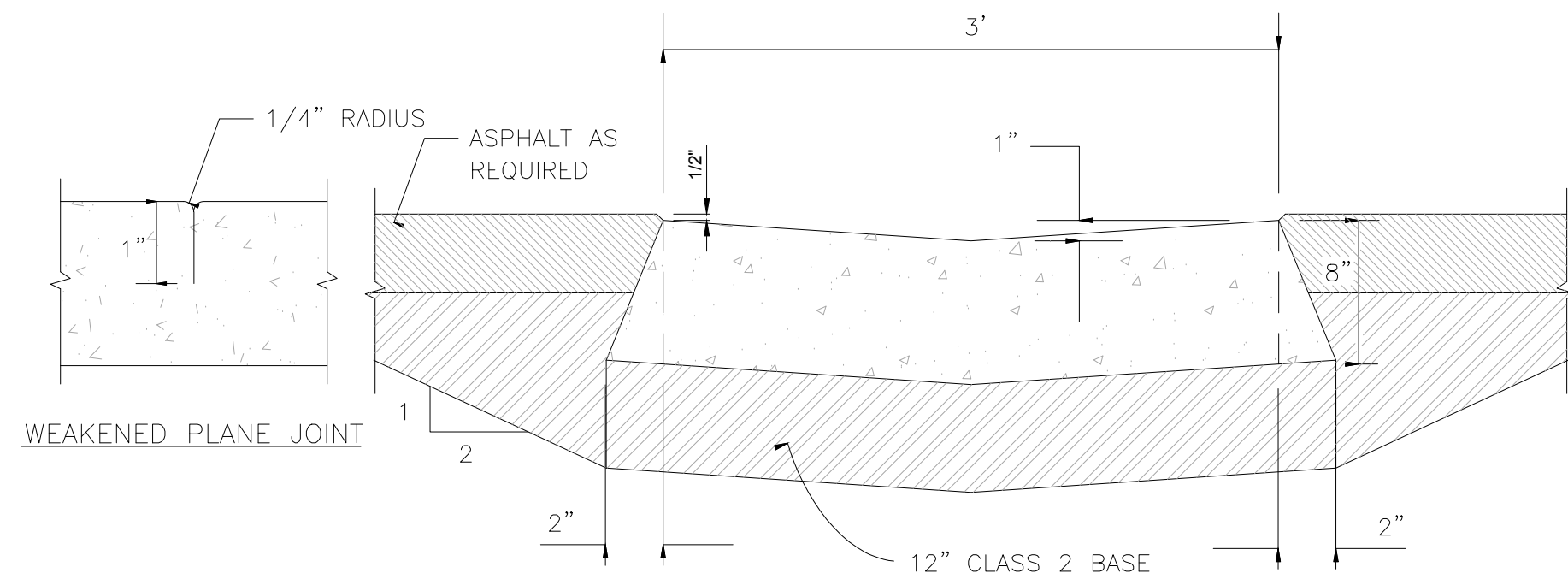

NOTES:

1. MINIMUM DRAINAGE SLOPE OF GUTTER SHALL BE AS SHOWN ON PLANS.
2. RIBBON GUTTER SHALL BE 6.25 SACK 4,500 PSI TYPE V PORTLAND CEMENT WITH A MAXIMUM WATER CEMENT RATIO OF 0.45 (BY WEIGHT) IN ACCORDANCE WITH ASTM C39/C39M-99 AND SHALL CONTAIN 1-1/2 LBS. POLYPROPYLENE FIBER PER CUBIC YARD. POLYPROPYLENE FIBER BY FIBERMESH CO., FORTA MONO, O.A.E.
3. CURING COMPOUND SHALL BE CURE-TREAT (CONCRETE CONDITIONER AND CURING AIDE) AS MANUFACTURED BY W.R. MEADOWS, INC. OR APPROVED EQUAL. COMPOUND SHALL BE APPLIED IN ACCORDANCE WITH MANUFACTURERS RECOMMENDATION.
4. WEAKENED PLANE JOINT 20' O.C.
5. CLASS 2 BASE MATERIAL SHALL BE COMPACTED TO 95% OF MAXIMUM DENSITY PER ASTM D-1557.
6. ALL METAL FORM STAKES MUST HAVE PROTECTIVE DEVICES SUCH AS "MUSHROOMS" INSTALLED AT ALL TIMES DURING USE, TO ADEQUATELY INSURE THE PUBLIC SAFETY.
7. CONCRETE SHALL BE MEDIUM BROOMED FINISHED AND TROWELED SMOOTH 8" WIDE ALONG THE FLOWLINE.

1 RIBBON GUTTER DETAIL

NOT TO SCALE

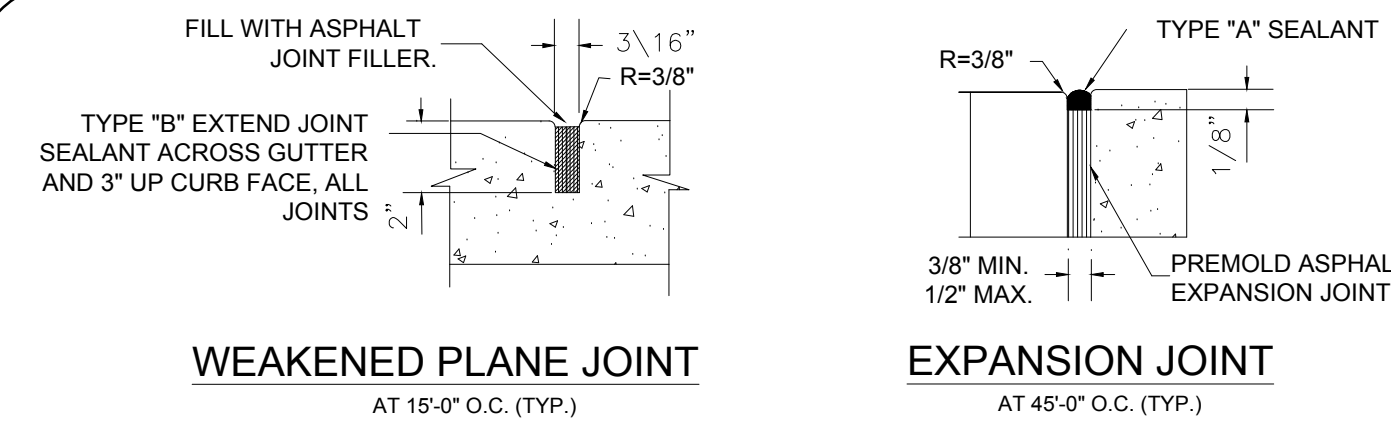

WEAKENED PLANE JOINT
AT 15'-0" O.C. (TYP.)

EXPANSION JOINT
AT 45'-0" O.C. (TYP.)

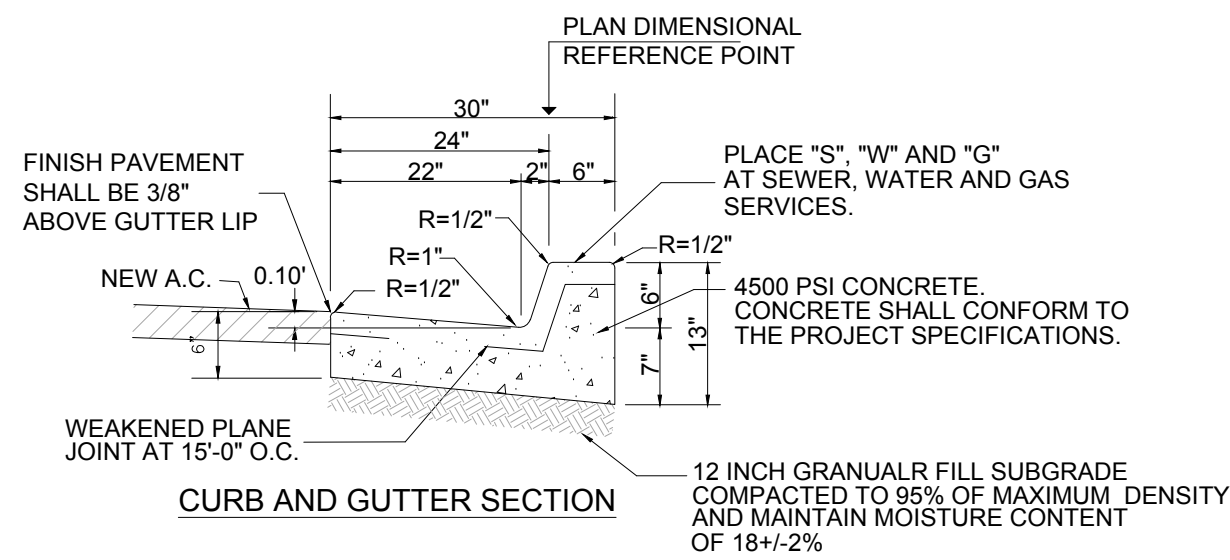

NOTES:

1. EXPANSION JOINTS TO BE INSTALLED AT ALL B.C.'S, E.C.'S CURB RETURNS AND STRUCTURES IN ADDITION TO 45' O.C.
2. CURB AND GUTTER SHALL BE 6.25 SACK 4,500 PSI TYPE V PORTLAND CEMENT WITH A MAXIMUM WATER CEMENT RATIO OF 0.45 (BY WEIGHT) IN ACCORDANCE WITH ASTM C39/C39M-99 AND SHALL CONTAIN 1-1/2 LBS. POLYPROPYLENE FIBER PER CUBIC YARD. POLYPROPYLENE FIBER BY FIBERMESH CO., FORTA MONO, O.A.E.
3. WIDTH OF STANDARD STREET SECTIONS SHOWN ON PLANS ARE TO CURB LINES UNLESS OTHERWISE INDICATED.
4. CURING COMPOUND SHALL BE SPRAYED UNIFORMLY ON EXPOSED SURFACES. HYDRO-CURE CLEAR CC-309-1W, OR APPROVED EQUAL.
5. WHEN CURB AND GUTTER IS PLACED BY AN EXTRUSION MACHINE MINOR FINISHING SHALL BE DONE TO PROVIDE AN ACCEPTABLE FINISH AND THE WEAKENED PLANE JOINT MAY BE SAWCUT.
6. ALL METAL FORM STAKES MUST HAVE PROTECTIVE DEVICES SUCH AS "MUSHROOMS" INSTALLED AT ALL TIMES DURING USE, TO ADEQUATELY INSURE THE PUBLIC SAFETY.
7. ALL EXPOSED SURFACES TO HAVE A SMOOTH TROWEL FINISH. DRY SACK FINISH WILL NOT BE ALLOWED.
8. THE CURB EDGES SHALL BE PLACED TRUE TO LINE AND GRADE. VERTICAL ELEVATIONS SHALL NOT VARY MORE THAN ±0.01' WITH A MAXIMUM VARIANCE OF 0.02' FROM DESIGN GRADE OCCURRING IN ANY GIVEN 100 FOOT SECTION. THE HORIZONTAL CURB EDGES SHALL NOT VARY MORE THAN 1/4" INCH IN ANY GIVEN 100 FOOT SECTION.

2 CURB AND GUTTER DETAIL No 400

NOT TO SCALE

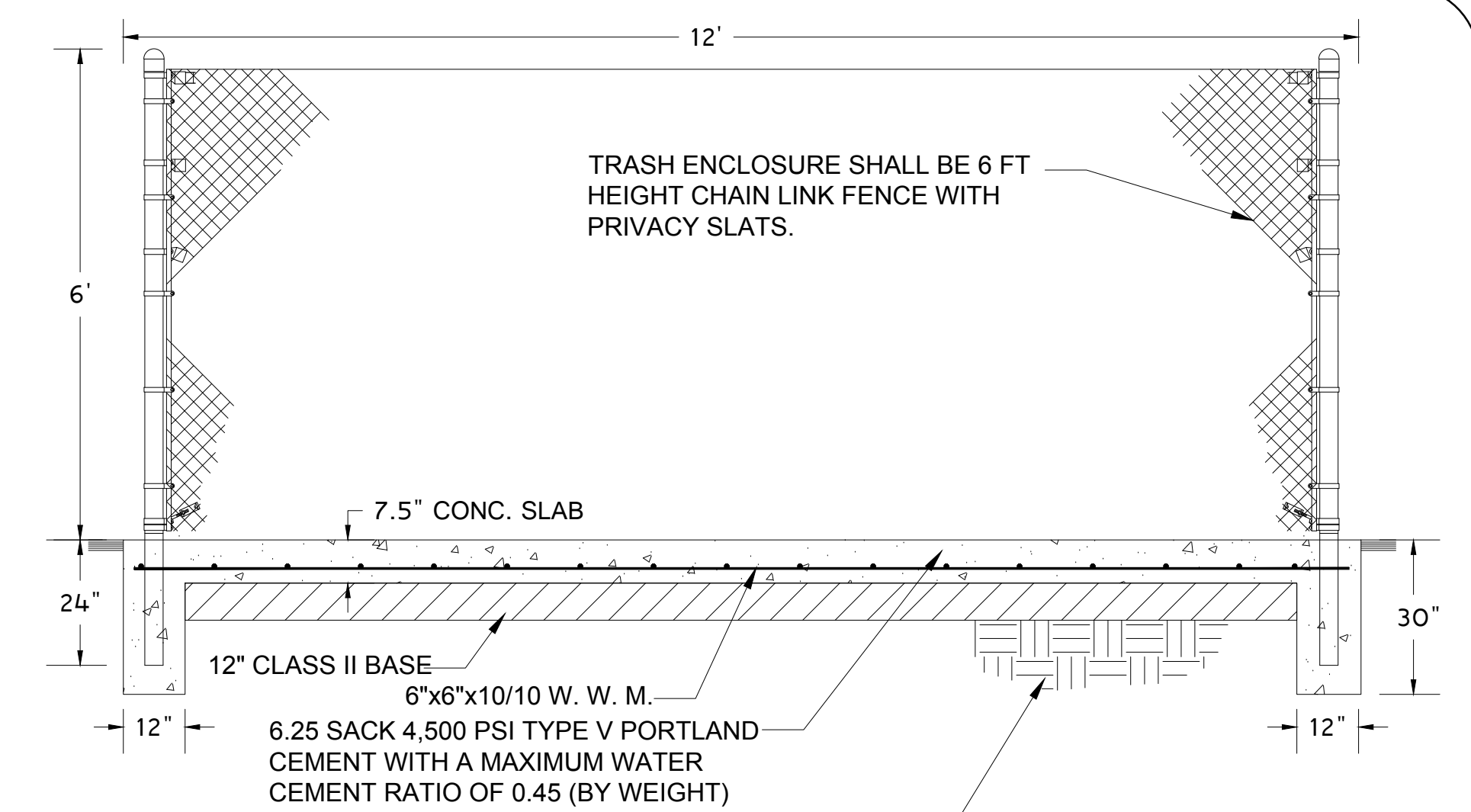

TRASH ENCLOSURE SHALL BE 6 FT HEIGHT CHAIN LINK FENCE WITH PRIVACY SLATS.

SUB-BASE SHALL BE A MIN. 24" OF 90% OF MAXIMUM DENSITY ASTM D1557 AT MIN. 5% ABOVE OPTIMUM MOISTURE. SEE GEOTECHNICAL REPORT.

USE AND SECTION	STEEL POST SCHEDULE		
	MINIMUM OUTSIDE DIMENSIONS (NOMINAL)		
	FABRIC WIDTH 72" OR LESS	FABRIC WIDTH 84" TO 96"	FABRIC WIDTH 108" AND OVER
CORNER, END & PULL POSTS			
TUBULAR - ROUND	2.375" O.D.	2.875" O.D.	4.00" O.D.
LINE POSTS			
TUBULAR - ROUND	1.90" O.D.	2.375" O.D.	2.875" O.D.
TOP, BOTTOM & BRACE RAILS			
TUBULAR - ROUND	1.66" O.D.		

3 TRASH ENCLOSURE DETAIL

NOT TO SCALE

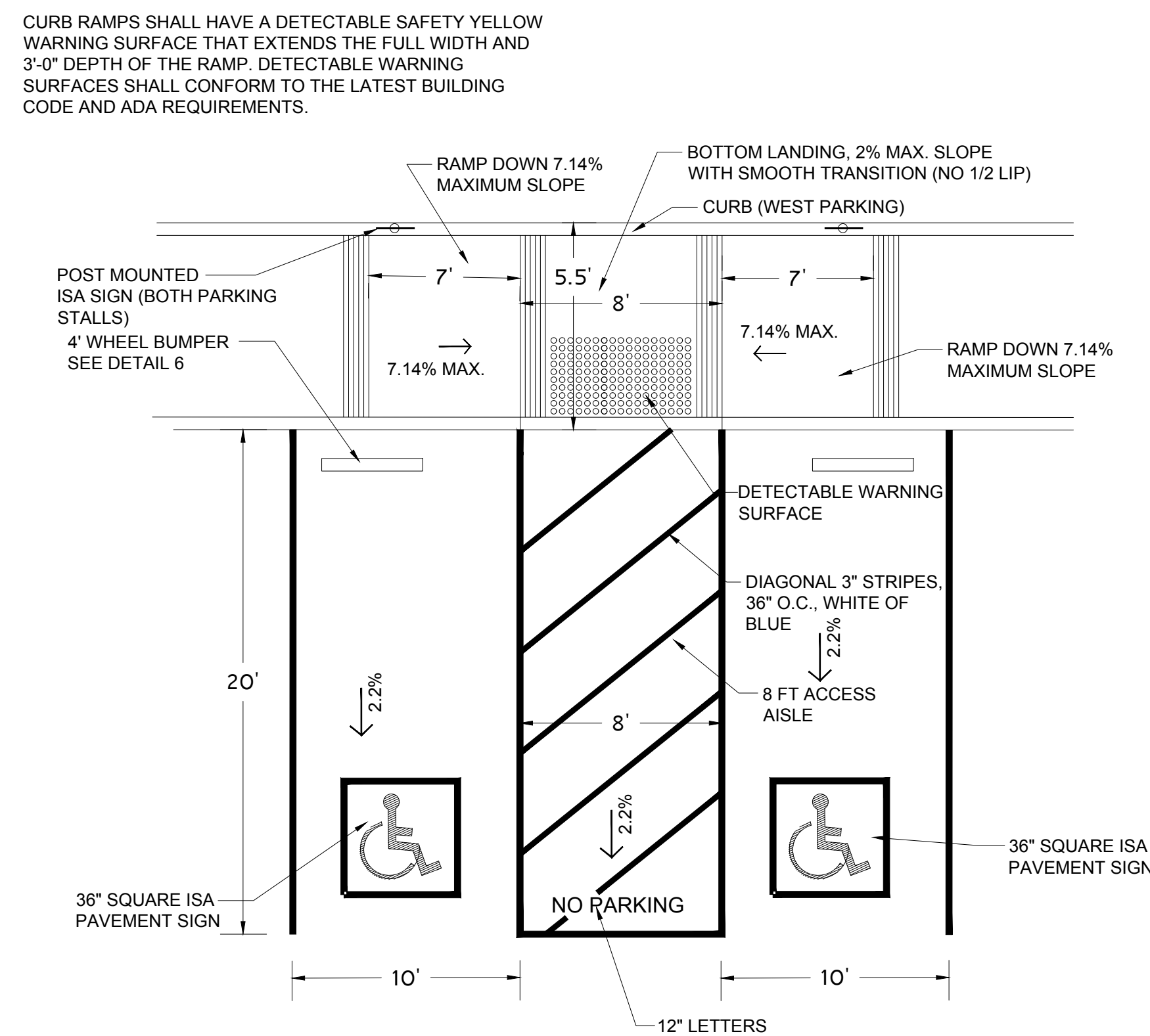

4 TYPICAL ACCESSIBLE PARKING DETAIL

NOT TO SCALE

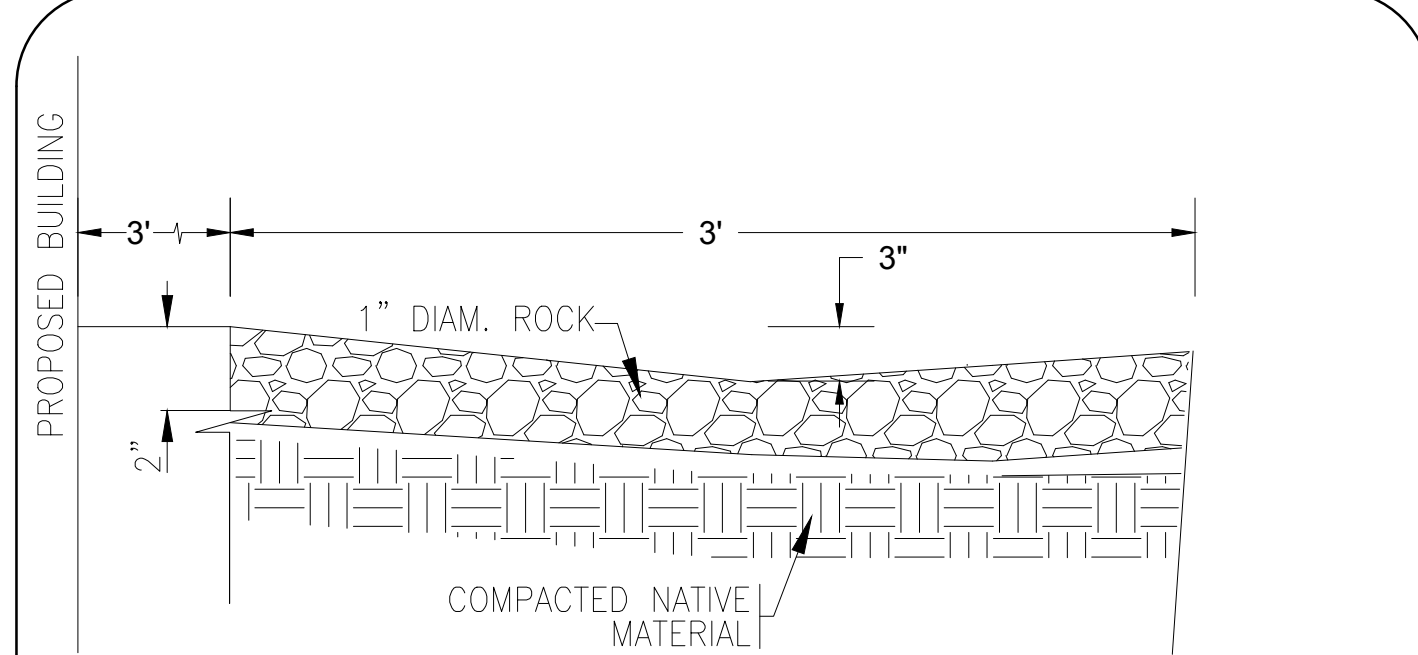

5 DRAINAGE SWALE

NOT TO SCALE

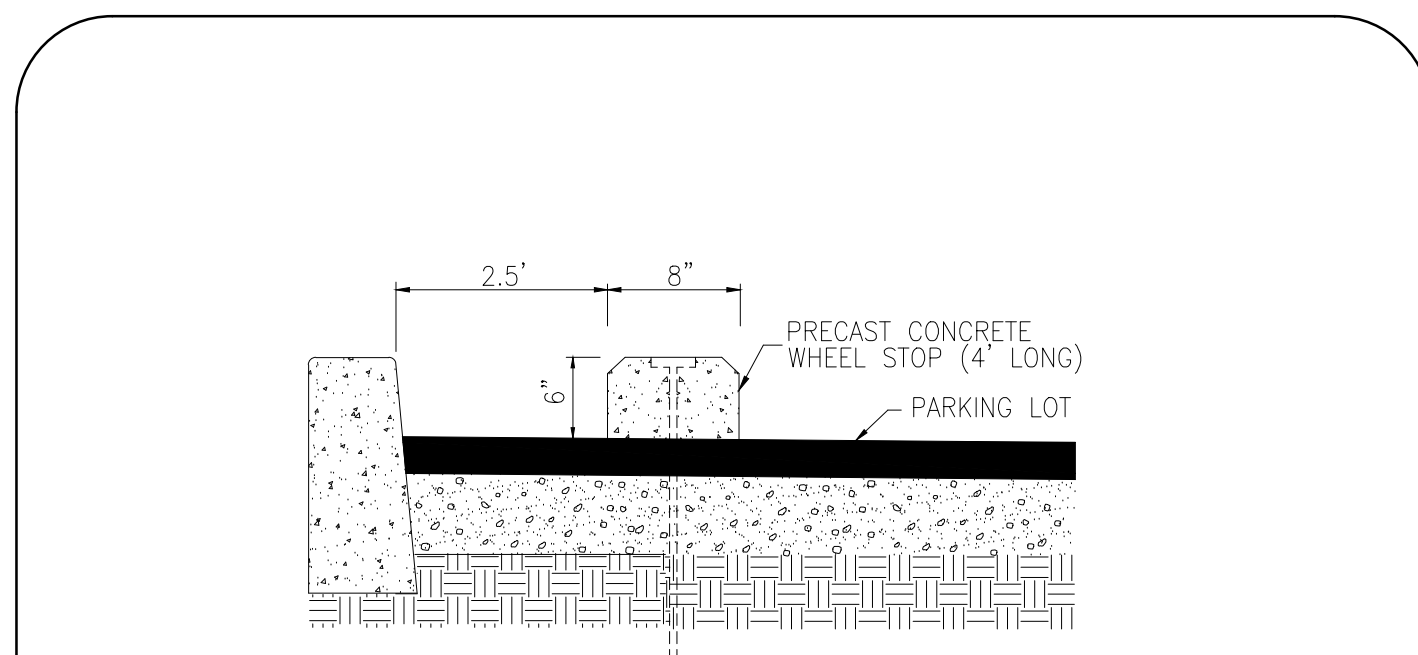

6 WHEEL STOP DETAIL

NOT TO SCALE

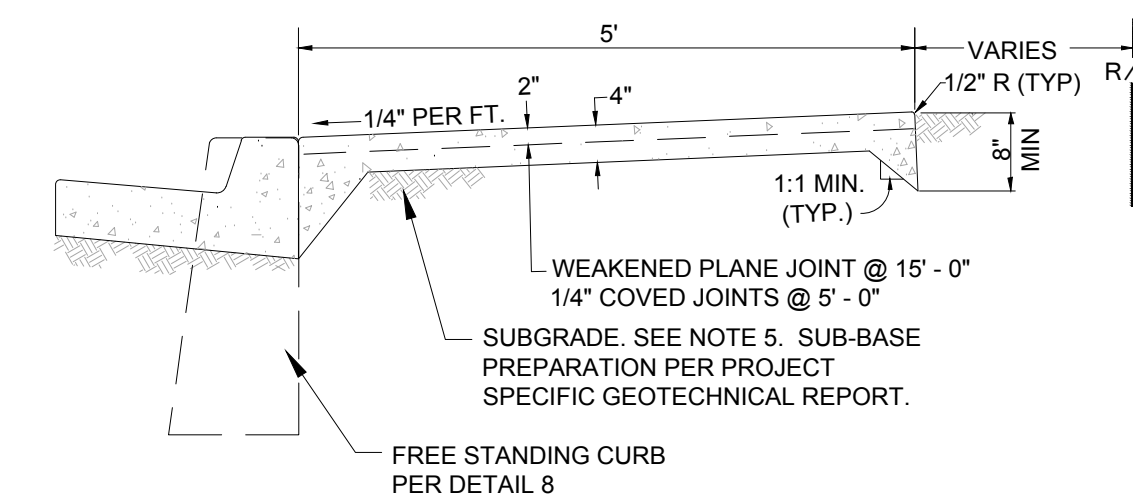

NOTE:

1. ALL METAL FORM STAKES MUST HAVE PROTECTIVE DEVICES SUCH AS "MUSHROOMS" INSTALLED AT ALL TIMES DURING USE, TO ADEQUATELY INSURE PUBLIC SAFETY.
2. EXPANSION JOINTS TO BE INSTALLED AT ALL B.C.'S, E.C.'S, CURB RETURNS AND STRUCTURES IN ADDITION TO 45' O.C.
3. FOR JOINTS DETAILS SEE GATEWAY STD. DWG. 400
4. SIDEWALK AND CURB SHALL NOT BE POURED MONOLITHIC.
5. SUBGRADE SHALL BE 12" INCHES MINIMUM OF CLASS II BASE COMPACTED TO 95% OF ASTM D1557 MAXIMUM DRY DENSITY.
6. CONTIGUOUS SIDEWALK SHALL BE 6.25 SACK 4,500 PSI TYPE V PORTLAND CEMENT WITH A MAXIMUM WATER CEMENT RATIO OF 0.45 (BY WEIGHT) IN ACCORDANCE WITH ASTM C39/C39M-99 AND SHALL CONTAIN 1-1/2 LBS. POLYPROPYLENE FIBER PER CUBIC YARD. POLYPROPYLENE FIBER BY FIBERMESH CO., FORTA MONO, O.A.E.

7 CONTIGUOUS SIDEWALK DETAIL No 420

NOT TO SCALE

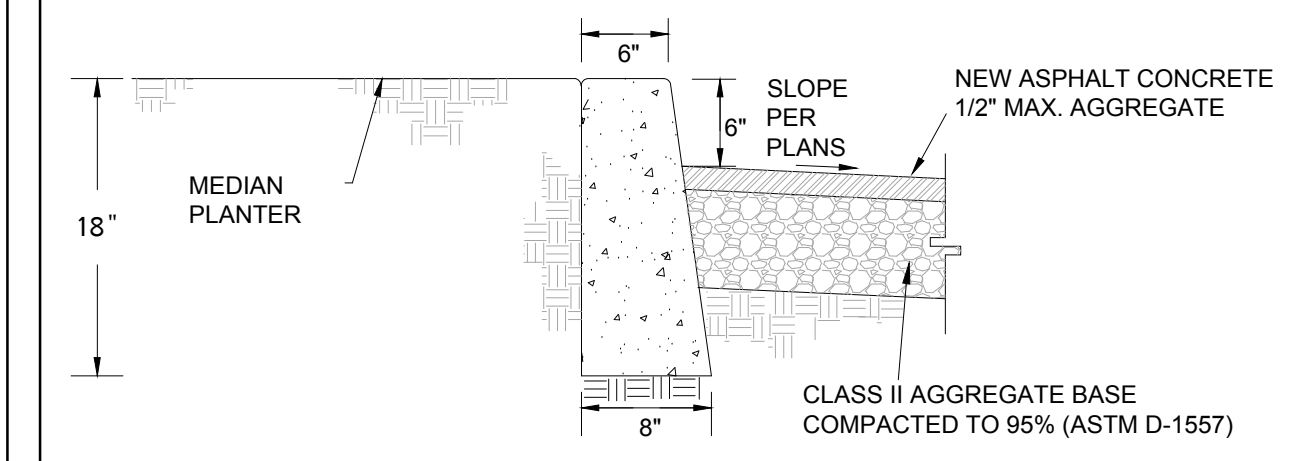

NOTE:

1. ALL METAL FORM STAKES MUST HAVE PROTECTIVE DEVICES SUCH AS "MUSHROOMS" INSTALLED AT ALL TIMES DURING USE, TO ADEQUATELY INSURE PUBLIC SAFETY.
2. PLACE WEAKENED PLANE JOINTS EVERY 15' (LINEAR FEET) ALONG THE CURB.
3. PLACE EXPANSION JOINTS EVERY 45' (FEET) EXPANSION JOINT MATERIAL TO BE COMPOSED OF 1/4" FIBER BOARD INSTALLED ACROSS SECTION OF CURB.
4. THE CURB EDGES SHALL BE PLACED TRUE TO LINE AND GRADE. VERTICAL ELEVATIONS SHALL NOT VARY MORE THAN ±0.01' WITH A MAXIMUM VARIANCE OF 0.02' FROM DESIGN GRADE OCCURRING IN ANY GIVEN 100 FOOT SECTION. THE HORIZONTAL CURB EDGES SHALL NOT VARY MORE THAN 1/4" IN ANY GIVEN 100 FOOT SECTION.
5. THE PCC SHALL ATTAIN A COMPRESSIVE STRENGTH OF 4500 PSI WITH A 0.45 WATER CEMENT RATIO AFTER 28 DAYS CURING.
6. THE STANDING CURB WILL HAVE THE SAME CONDITIONS FOR CONSTRUCTION ADJACENT TO THE PROPOSED PLANTERS.
7. FREE STANDING CURB SHALL BE 6.25 SACK 4,500 PSI TYPE V PORTLAND CEMENT WITH A MAXIMUM WATER CEMENT RATIO OF 0.45 (BY WEIGHT) IN ACCORDANCE WITH ASTM C39/C39M-99 AND SHALL CONTAIN 1-1/2 LBS. POLYPROPYLENE FIBER PER CUBIC YARD. POLYPROPYLENE FIBER BY FIBERMESH CO., FORTA MONO, O.A.E.

8 FREE STANDING CURB DETAIL No 427

NOT TO SCALE

Dynamic CONSULTING ENGINEERS

CIVIL ENGINEERING - LAND SURVEYING - CONSTRUCTION MANAGEMENT
2415 IMPERIAL BUSINESS PARK DRIVE, SUITE B.,
IMPERIAL CA. 92251
TEL. (760) 545-0162 FAX (760) 545-0163

REVISION	DATE	COMMENTS
	03/25/2016	PLANS ISSUED FOR PLAN CHECK REVIEW AND PERMITTING

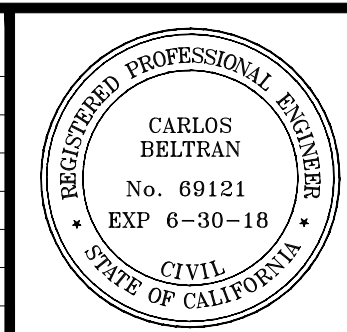

PREPARED UNDER THE DIRECT SUPERVISION OF:
CARLOS BELTRAN, P.E. 69121 R.C.E. No.
DATE 06/30/2018 REG. EXP.

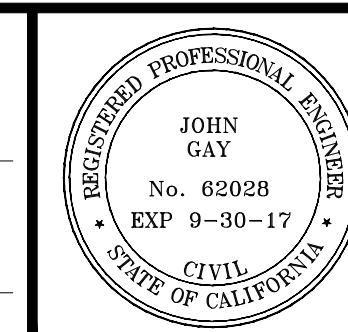

COUNTY OF IMPERIAL PUBLIC WORKS DEPARTMENT
APPROVED FOR CONSTRUCTION BY:
JOHN GAY, P.E. 62028 R.C.E. No.
DIRECTOR OF PUBLIC WORKS 09/30/2017 REG. EXP.

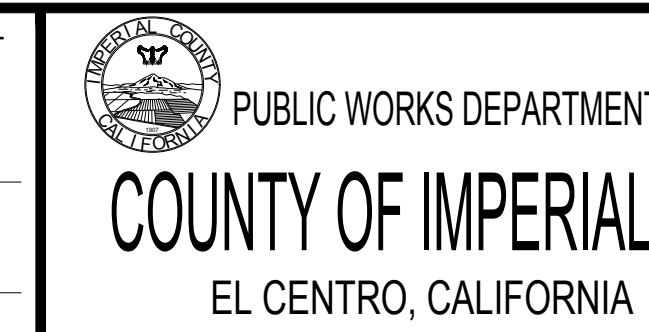

DATE 03/17/2017
DRAWN DB
SCALE AS SHOWN
CHECKED CB

PUBLIC SAFETY FACILITY IMPROVEMENTS LOCATED AT
518 RAILROAD AVE., WINTERHAVEN CA;
COUNTY PROJECT NO. SR5315ADM

DETAILS
REFERENCE PROJECT NO. SR5315ADM
SHEET 4 OF 7